

Common Issues

The tips below assume your computer meets the general computer requirements for the school found [here](#).

1. I'm getting this error saying the program is out of date



If you see this error, you have to manually approve the installation of OMS. This is done by going to system preferences (clicking the Apple icon at the top left of your screen) then navigating to security and privacy and clicking the open anyways button like shown below.

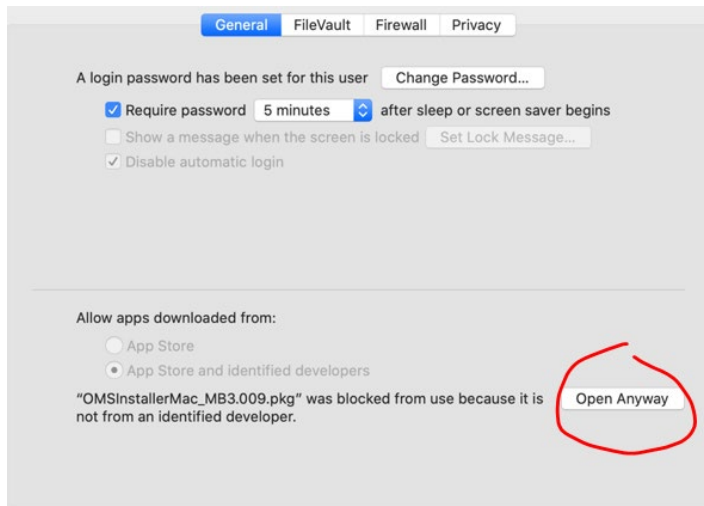

2. When I start OMS I just see a black screen and nothing happens

Close OMS then close every other program open in the background (Example: PowerPoint, Word etc) before trying to start OMS again. If it still happens, restart your computer and try OMS again.

3. Movement within OMS seems choppy

If using a laptop, make sure it is plugged into power when using OMS.